

3D VIEW

Model No:	Temperature Range (°C)	No. of tiers	Growth height	Light Intensities (6" from lamp)
PGSP-1	4°C - 40°C (Lights off) 10°C- 40°C (Lights on)	1	73.5" per tier	500 -1000 μ moles/ m ² /s @ 25°C per tier
PGSP-2	4°C - 40°C (Lights off) 10°C- 40°C (Lights on)	2	36" per tier	500 -1000 μ moles/ m ² /s @ 25°C per tier
PGSP-3	4°C - 40°C (Lights off) 10°C- 40°C (Lights on)	3	22" per tier	500 -1000 μ moles/ m ² /s @ 25°C per tier

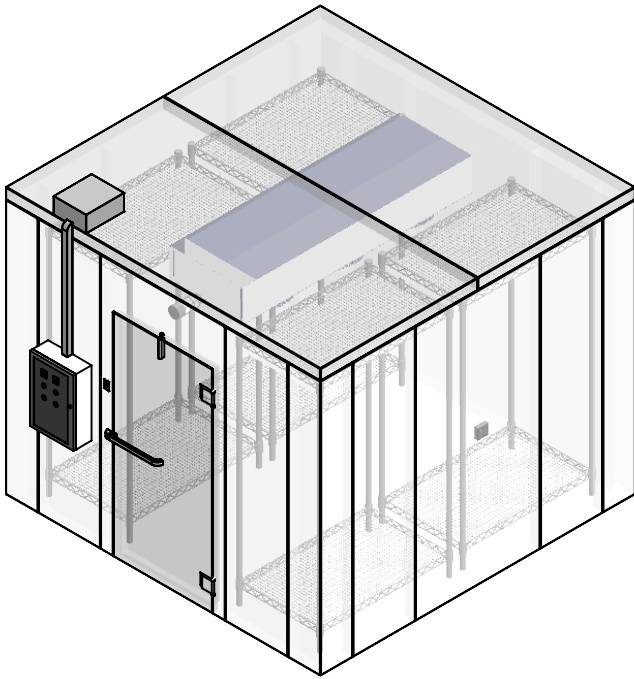

PGSP - 1

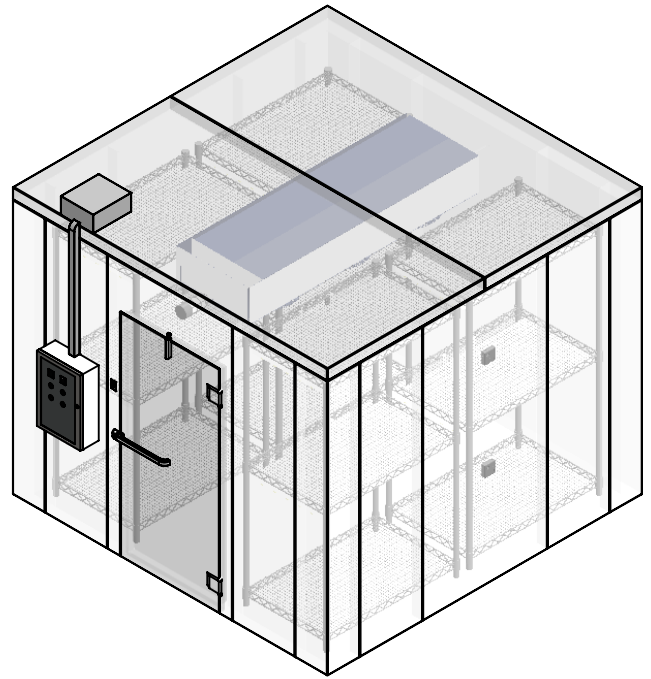

PGSP - 2

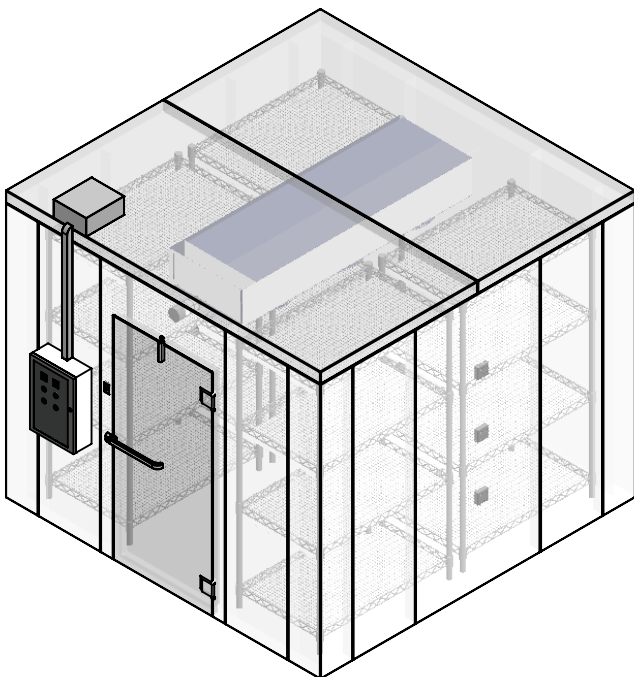

PGSP - 3

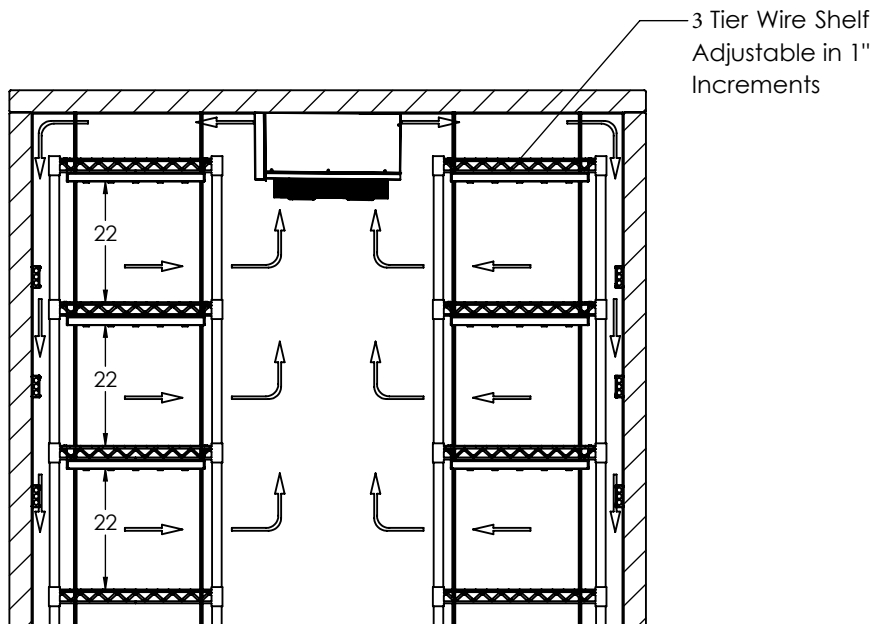
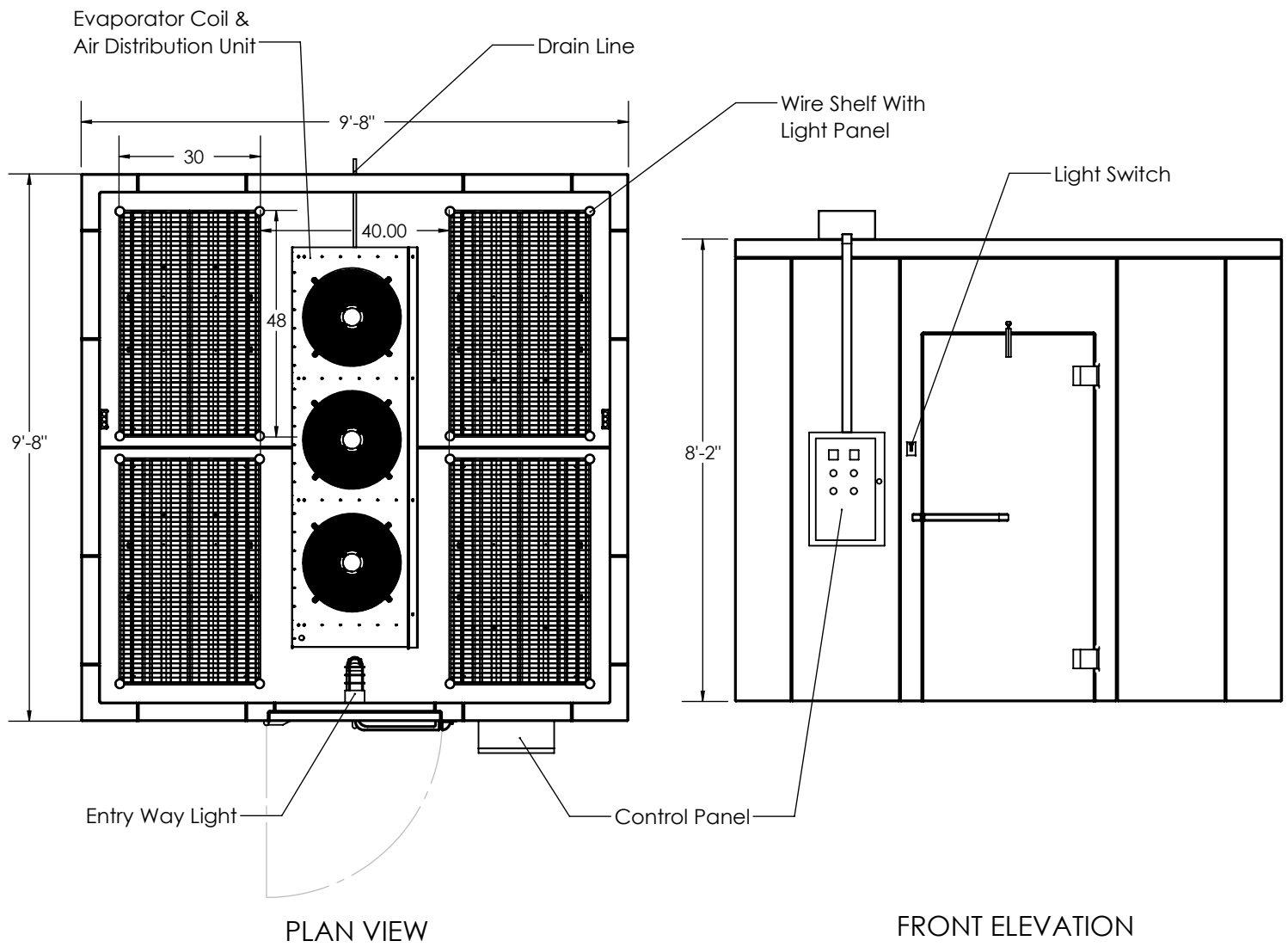

PGSP - 3
(SECTION)

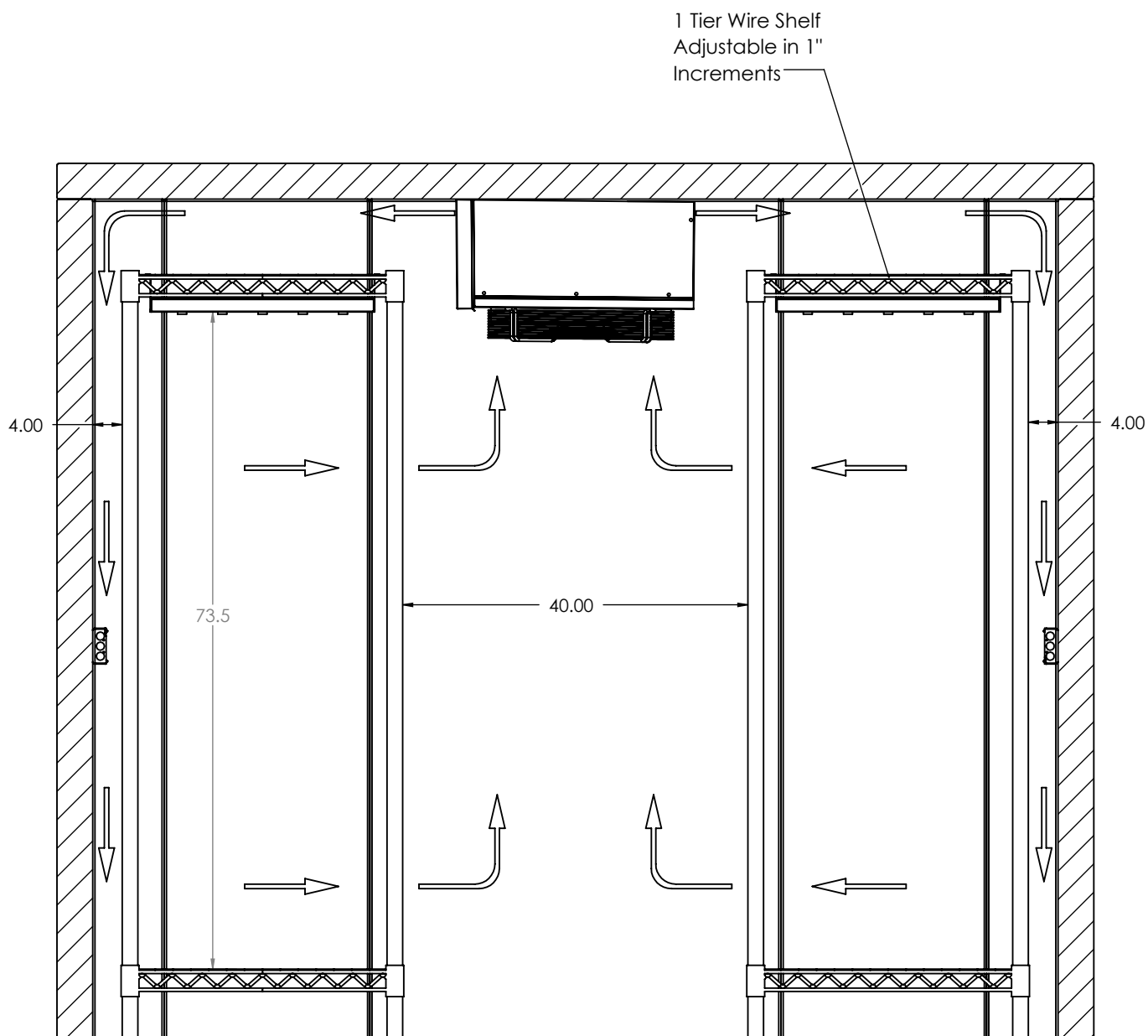

PGSP - 1
(SECTION VIEW)

Note:- 86" H shelving unit shown in drawing. 74" H shelving unit is available.
Growth height may vary depending on shelving unit height.

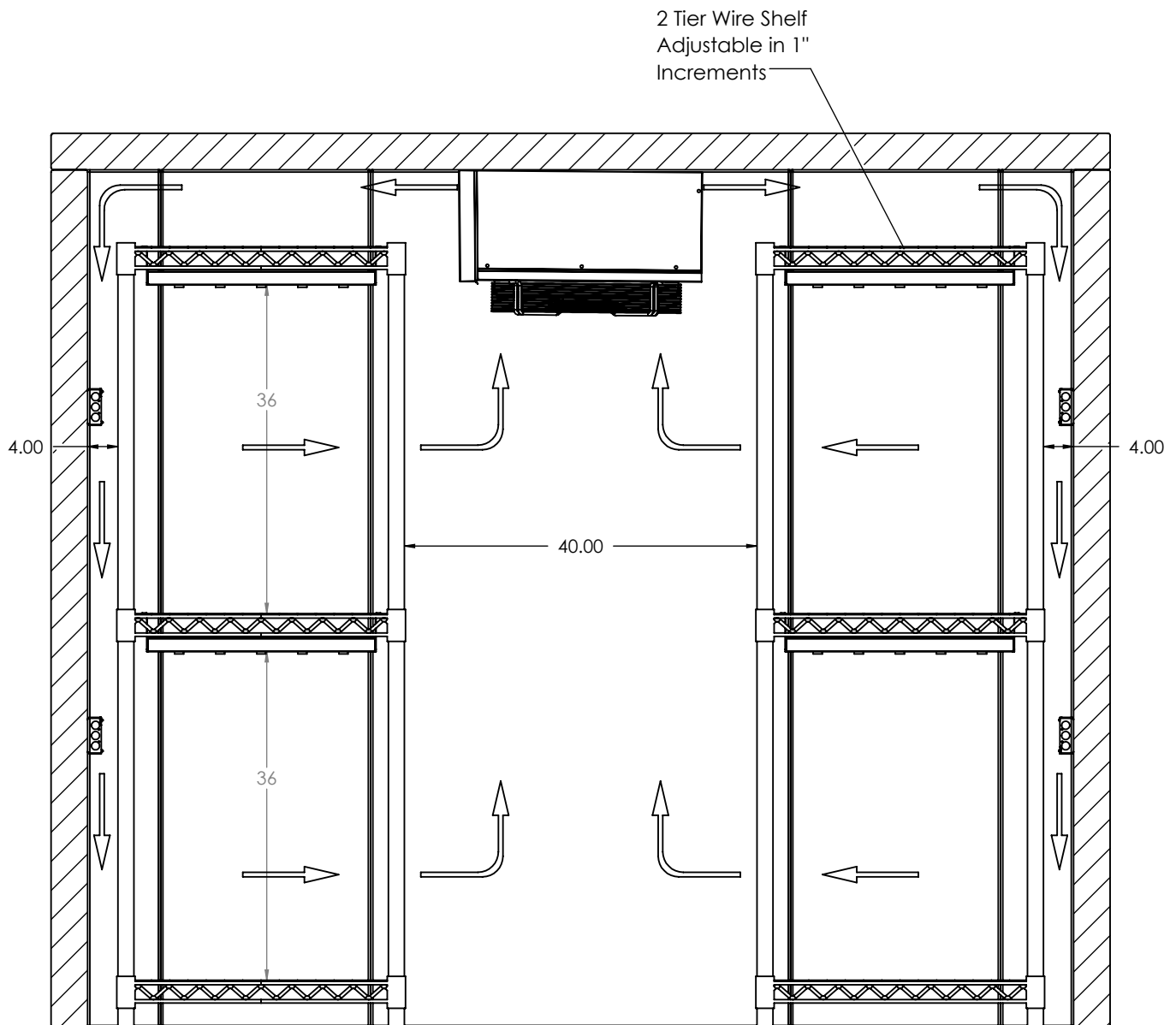

PGSP - 2
(SECTION)

Note:- 86" H shelving unit shown in drawing. 74" H shelving unit is available.
Growth height may vary depending on shelving unit height.

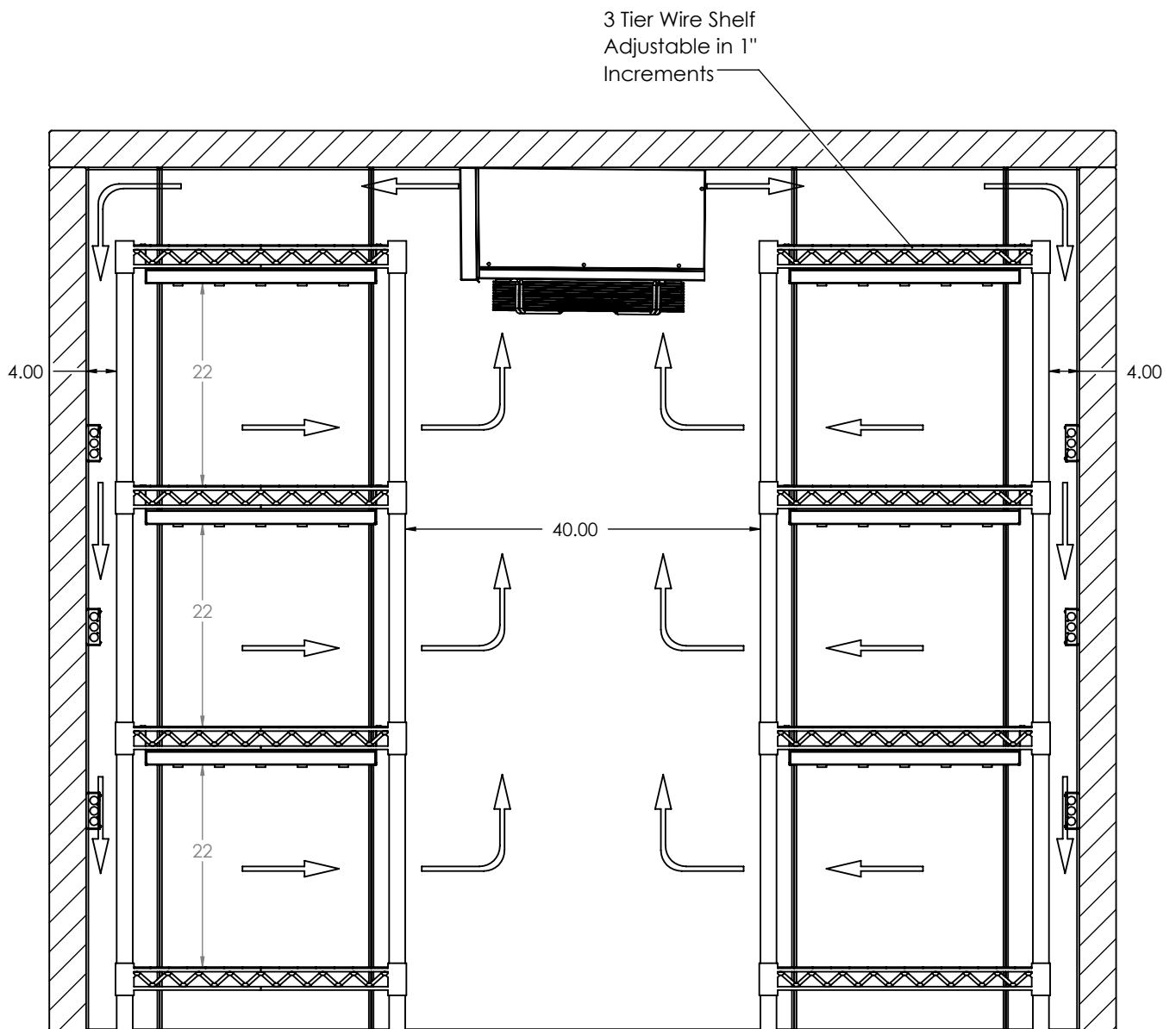

PGSP - 3
(SECTION)

Note:- 86" H shelving unit shown in drawing. 74" H shelving unit is available.
Growth height may vary depending on shelving unit height.