

LT09 REFRIGERATOR CHAMBER

LT Series Overview

The LT series refrigerators provide the highest level of performance and construction with tight uniformity and control of temperature. They are common product among laboratory researchers looking for exceptional precision and virtually unlimited customization options available.

LT09

The LT09 is a bench top lab refrigerator chamber designed to fit on 24" benchtops or stacked with optional racking.

LT030

The LT030 is a single-door lab refrigerator.

LT034

The LT034 is a single-door lab refrigerator chamber designed for maximum capacity while still allowing passage through most commercial doorways.

LT055

The LT055 is a 2-door lab refrigerator.

LT084

The LT084 is a 3-door lab refrigerator.



Featured photo is the LT09 bench top lab refrigerator chamber, featured upgraded West controller, open door view to show adjustable internal racks.



Featured photo is the LT09 bench top lab refrigerator chamber, closed door view.

LT SERIES: REFRIGERATOR CHAMBERS

The LT series come standard with the following: temperature range of 2° C to 15° C. Control of temperature at sensor of $\pm 0.2^{\circ}$ C. Uniformity inside chamber of $\pm 1.0^{\circ}$ C. Standard Microprocessor Controller with PID, autotuning, programmable alarms, ability to ramp/soak, process variable and set-point variable offset, dual display of actual temperature and set-point temperature (process variable and set-point variable). Controls are able to be quickly exchanged for future upgrades or repair. As always, if you have different specifications, probes, microprocessors, etc. we can probably do it.

Options Available

Data Logging
Chart Recording
Touch Screen Controls

Widely Proven, Non-Proprietary Controllers

Standard controllers for the LTseries are manufactured by Fuji Electric and are ideal for stability testing chambers. Unlike many proprietary controllers, this controller is commercially available and proven in tens of thousands of installations. Standard functions include: autotuning, fuzzy logic, PID control, programmable alarms, calibration capability, ramp/soak, offset capability, etc. A touchscreen control interface is optional. Other controller manufacturers are also supported (Watlow, Allen Bradley etc.)

Services and Warranties

We offer 24 hour technical support throughout the lifetime of your chamber. In addition to our standard warranties, we also offer extended warranties for cooling components, parts and labor. We also provide qualifications, validations and preventive maintenance services at an additional cost. Please ask for a quote.

LT09 Refrigerator Chamber Specifications (ambient 21° C)

Performance	Standard	Customized Option
Temperature Range	2° C to 15° C	Available
Ambient Temperature	21° C to 3° C	Available
Temperature Control	± 0.2° C	Available
Temperature Uniformity	± 0.7° C	Available
Control Resolution	0.1° C	Available
Temperature Sensor	NIST Traceable PT100RTD Class A	Available

Control System	Standard	Customized Option
Controller	Microprocessor based PID	West EC-44, Future Design Touchpad + More
Control Readout	Actual and Set-Point Values	Trending, Duty Cycle
Calibration Correction Capability	Actual and Set-Point Values	Available
Uniformity Off Set	Standard 0.1 Resolution	Available
Alarm	Audible and Visual	Text, Email, Web Server, Remote Access
Alarm Type	Deviation in 0.1° C or 0.1% RH with Delay	Absolute 0.1 Resolution with Delay
Remote Monitoring	Available	Dry Alarm Contact, RS 485 & Analog Output
Password Protection	Numeric	Numeric, Alpha Numeric
Audit Trail	N/A	Available
Uninterrupted Power Supply (Monitoring)	N/A	Available

Construction	Standard	Customized Option
Exterior	Powder Coated	304, 316 grade Stainless Steel Door, Front & Sides
Interior	20 ga 304 grade - #4 finish Stainless Steel	Available
Shelving	2 Stainless Steel Shelves, Adjustable 1/2" Increments	Available
Casters	2.75"H - qty-4 Caster Wheels	Leg Levelers and Seismic Legs

Capacity & Dimensions	US Standard	Metric
Interior Capacity	10.5 ft ³	297.33 liters
External Dimensions	Refer to Drawing Below	Refer to Drawing Below
Internal Dimensions	Refer to Drawing Below	Refer to Drawing Below
Shelf Dimensions	Refer to Drawing Below	Refer to Drawing Below
Crated Weight	470 lbs	213.19 kg

Utilities	US Standard	International
Voltage (dedicated circuit required)	115 / 60 / 1	230 / 50 / 1
RLA	4.2	2.6
Cord Length	9 ft	2.74m (specify plug)
Drain Line	Chambers are equipped with 1/4" polytube. Floor drain or sink required adjacent to chamber	Condensate pump option available, if floor drain is not available nearby



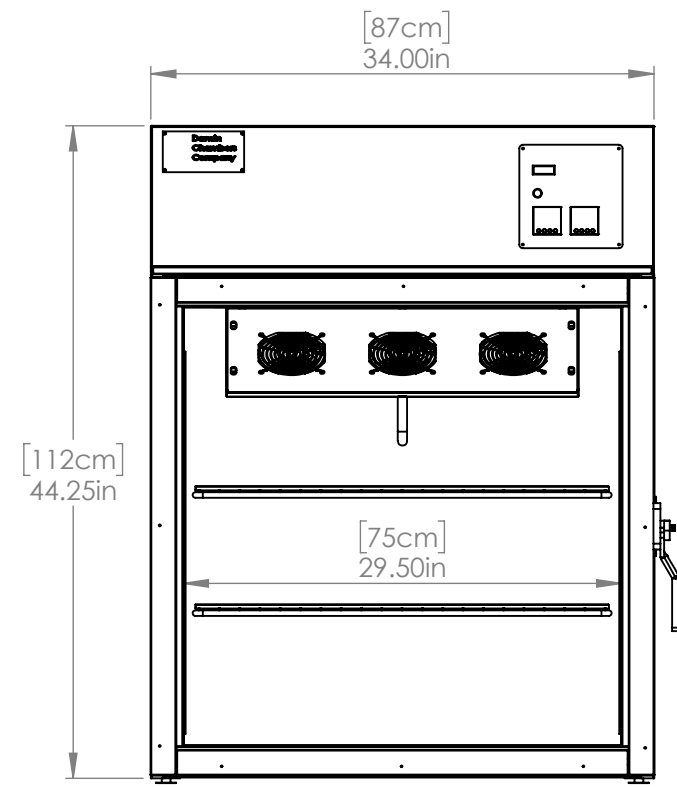

FRONT VIEW
(DOOR REMOVED)

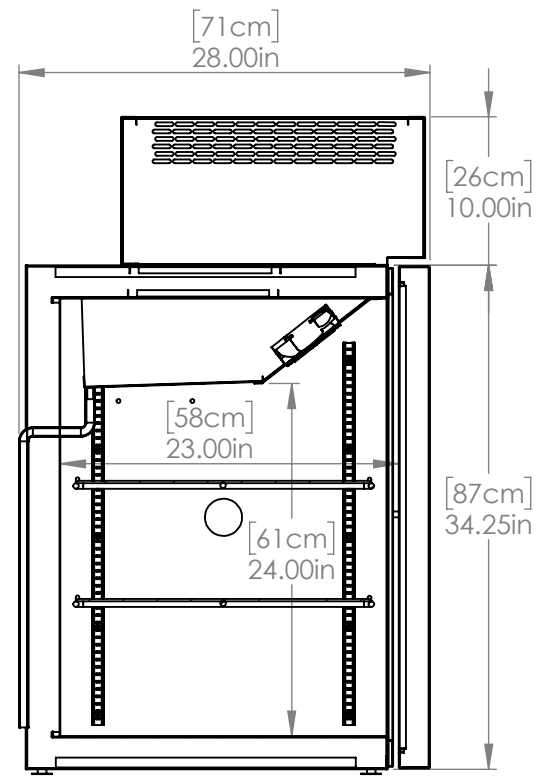

SIDE VIEW
(SECTION)

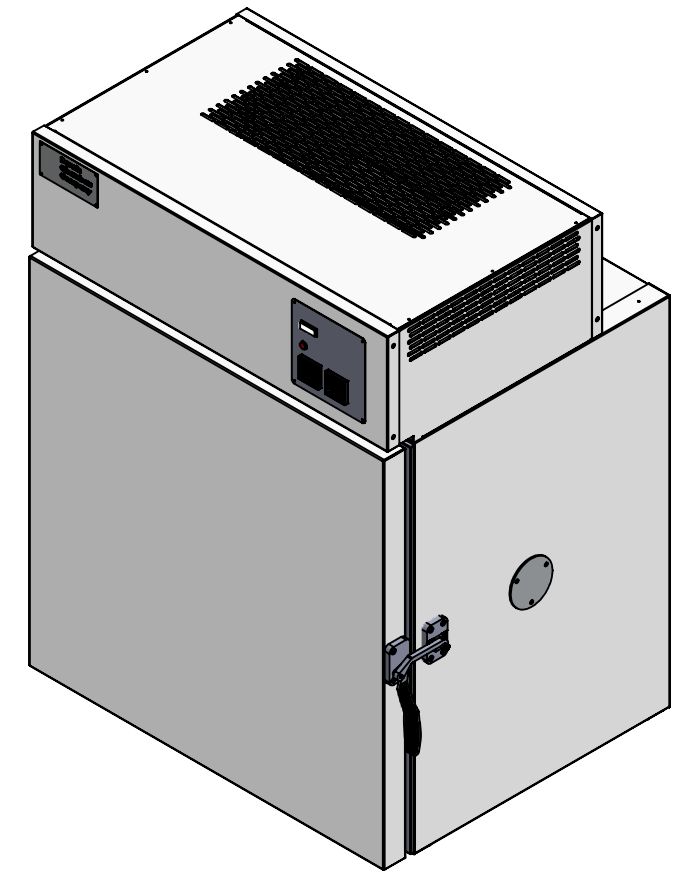

3D VIEW

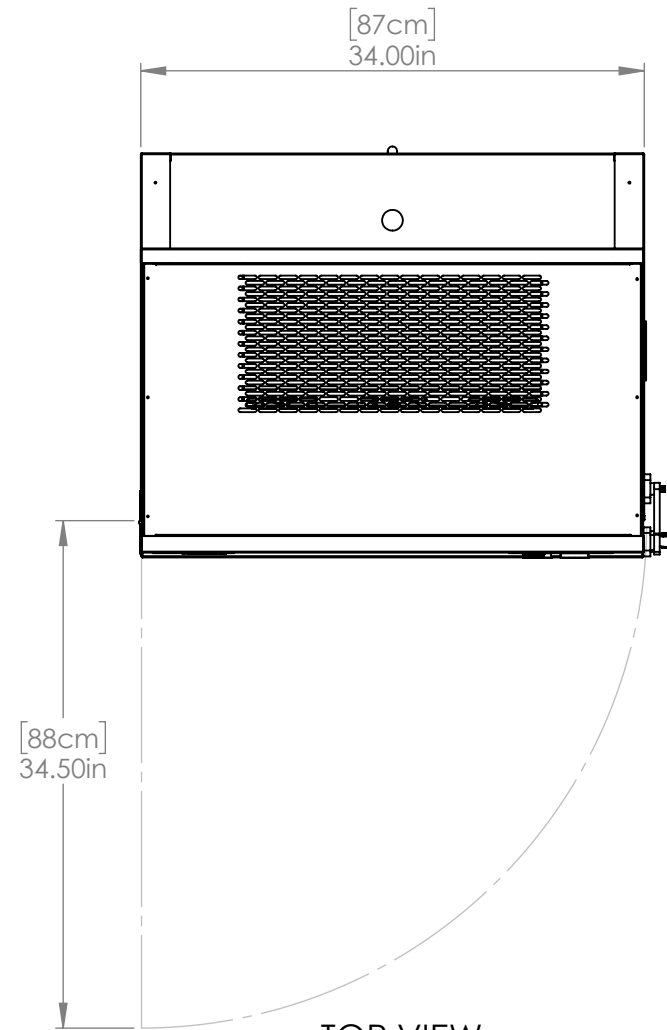

TOP VIEW

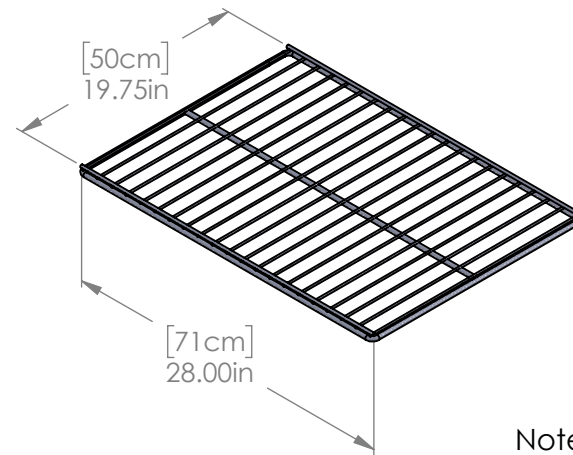

WIRE SHELF

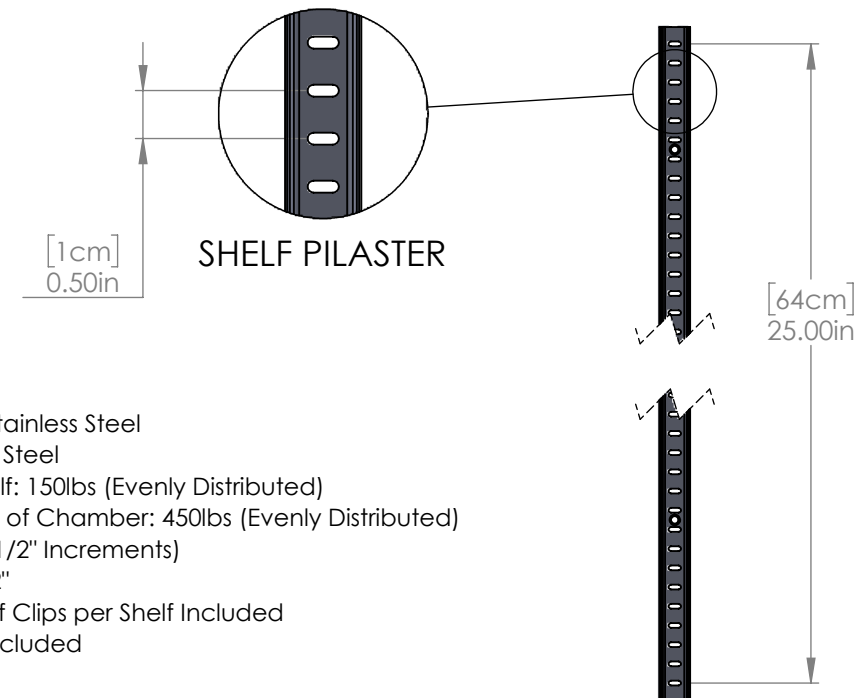

SHELF PILASTER

Notes:

- Shelf Material: 304 Stainless Steel
- Shelf Finish: Polished Steel
- Max Weight per Shelf: 150lbs (Evenly Distributed)
- Max Load Capacity of Chamber: 450lbs (Evenly Distributed)
- Pilaster Height: 25" (1/2" Increments)
- Minimum Spacing: 2"
- 4 Stainless Steel Shelf Clips per Shelf Included
- 2" I.D. Access Port Included

Note: Tolerances are 0.25" unless otherwise stated
*Dimensions and components are subject to change without notice.