

DUAL TEMPERATURE REFRIGERATOR/ FREEZER COMBOS

Series Overview

The dual temperature refrigerator/ freezer combination features separate microprocessor temperature controller which allows for precise temperature control, verification and recovery. An interior fan, forced-draft air circulation system is used and provides temperature uniformity when the door is opened for the refrigerator part. *Periodic manual defrosting is required (freezer). *Unit requires two outlets.

DTRF-9SS

Two stainless steel swing doors chamber designed for maximum capacity while still allowing passage through most commercial doorways.

Performance

Unit comes standard with a temperature range for the refrigerator: 1°C to 10°C and freezer temperature range: -15°C to -25°C. Manual defrost (freezer) and cycle defrost (refrigerator). Products designed to operate in ambient room temperatures not to exceed 75° F / 50% RH.

Control System

All series models come standard with a digital microprocessor temperature controller providing a readout of actual and set-point values. This chamber comes with audible/visual alarms, high and low temperature alarms with remote alarm contacts.

Warranties

These chambers come with a two year parts and labor warranty, plus an additional three year compressor parts warranty.



The Dual Temperature Refrigerator/ Freezer Combos take a large step forward in performance from past general purpose units; offering a digital temperature display and alarm module coupled with a microprocessor temperature controller.



Construction

Refrigerator/freezer combo is constructed of stainless steel exterior.

- 2 adjustable/ 1 fixed shelf refrigerator/2 fixed shelves freezer with guard rails on back in refrigerator to prevent product from being pushed against back wall
- Two stainless steel swing doors, right hinged
- Magnetic door gasket for positive seal with keyed door lock and recessed door handles
- Leveling legs
- Stacking kit
- Back wall evaporator cover (refrigerator)
- Probe access port (3/8"), one in refrigerator and one in freezer
- LED interior lights
- HFC-free refrigerant (R600a), foam insulation and packaging
- Exterior dimensions: 23.75" W x 24.5"D x 66.75"H
- Shipping weight: 266 lbs
- Voltage: 115 / 60 / 1.74 Amps refrigerator, 1.5 Amps freezer, 1/8 HP refrigerator and freezer
- UL/C-UL listed

Dual Temperature Refrigerator/ Freezer Combos Technical Drawings

Front View

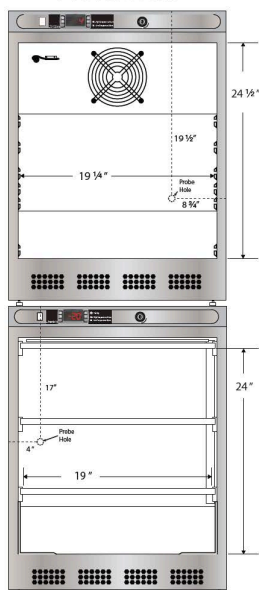

Side View

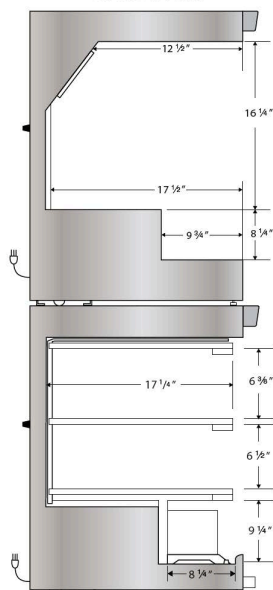
115VAC/60Hz/1PH
NEMA-5-15P

Compartment	Cu. Ft	Defrost	Door	Int Door	Shelves	Interior Dim.			Refrigerant	H.P.	Amps	Weight
						W"	D"	H"				
Refrigerator	4.5	Cycle	1 Solid	0	2 Adj./1 Fixed	19 1/4	17 1/2	24 1/2	R600a	1/8	1.74	200 lbs.
Freezer	4.2	Manual	1 Solid	0	2 Fixed	19	17 1/4	24		1/8	1.5	

Note: Interior dimensions are estimates and subject to change without notice

Front View

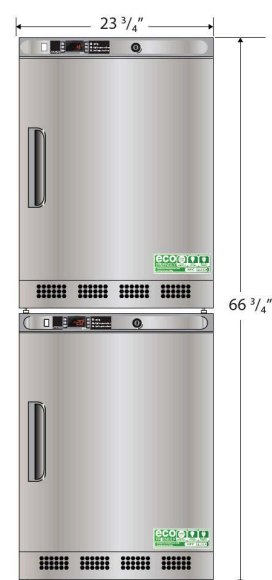

Side View

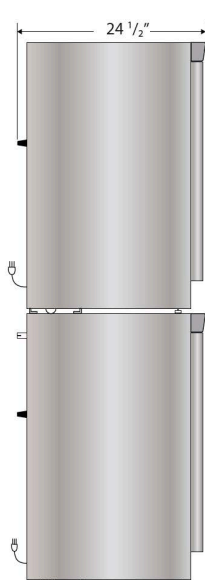

Top View

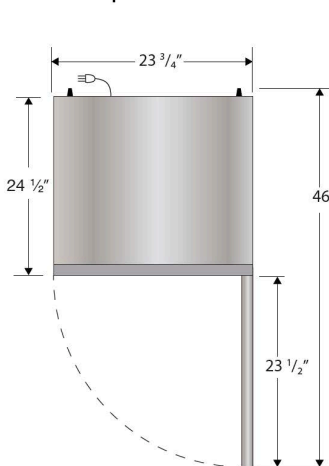
115VAC/60Hz/1PH
NEMA-5-15P

Compartment	Cu. Ft	Defrost	Door	Int Door	Shelves	Interior Dim.			Refrigerant	H.P.	Amps	Weight
						W"	D"	H"				
Refrigerator	4.5	Cycle	1 Solid	0	2 Adj./1 Fixed	23 3/4	24 1/2	66 3/4	R600a	1/8	1.74	200 lbs.
Freezer	4.2	Manual	1 Solid	0	2 Fixed	23 3/4	24 1/2	66 3/4		1/8	1.5	