

DUAL TEMPERATURE REFRIGERATOR/ FREEZER COMBOS

Series Overview

The dual temperature refrigerator/ freezer combination features separate microprocessor temperature controller which allows for precise temperature control, verification and recovery. An interior fan, forced-draft air circulation system is used and provides temperature uniformity when the door is opened for the refrigerator part. All units require a 4" clearance around the back and sides of the unit for ventilation. *Periodic manual defrosting is required (freezer). *Unit requires two outlets.

DTRF-9G-LH

Two exterior swing doors (glass door refrigerator/ solid door freezer) chamber designed for maximum capacity while still allowing passage through most commercial doorways.

Performance

Unit comes standard with a temperature range for the refrigerator: 1°C to 10°C and freezer temperature range: -15°C to -25°C. Manual defrost (freezer) and cycle defrost (refrigerator). Products designed to operate in ambient room temperatures not to exceed 75° F / 50% RH.

Control System

All series models come standard with a digital microprocessor temperature controller providing a readout of actual and set-point values. This chamber comes with audible/visual alarms, high and low temperature alarms with remote alarm contacts.

Warranties

These chambers come with a two year parts and labor warranty, plus an additional three year compressor parts warranty.



The Dual Temperature Refrigerator/ Freezer Combos take a large step forward in performance from past general purpose units; offering a digital temperature display and alarm module coupled with a microprocessor temperature controller.



Construction

Refrigerator/freezer combo is constructed of white powder coated exterior.

- 2 adjustable/ 1 fixed shelf refrigerator with guard rail on back to prevent product from being pushed against back wall
- 2 fixed shelves freezer
- Two exterior swing doors (glass door refrigerator/ solid door freezer), left hinged
- Magnetic door gasket for positive seal with keyed door lock
- Recessed door handle: freezer; heavy duty door handle: refrigerator
- Leveling legs
- Stacking kit
- Probe access port (3/8"), one in refrigerator and one in freezer
- LED interior light (refrigerator)
- High density urethane foam cabinet and door insulation
- HFC-free refrigerant (R600a), foam insulation and packaging
- Exterior dimensions: 23.75" W x 25.5"D x 66.75"H
- Shipping weight: 282 lbs
- Voltage: 115 / 60 / 1.74 Amps refrigerator, 1.5 Amps freezer, 1/8 HP refrigerator and freezer
- UL/C-UL listed

Dual Temperature Refrigerator/ Freezer Combos Technical Drawings

Front View

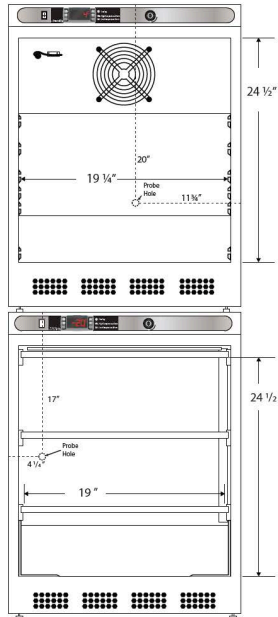

Side View

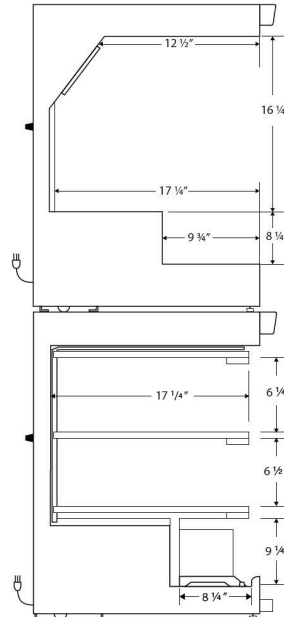

Compartment	Cu. Ft	Defrost	Door	Int Door	Shelves	Interior Dim.			Refrigerant	H.P.	Amps	Weight
						W"	D"	H"				
Refrigerator	4.6	Cycle	1 Glass LH	0	2 Adj./1 Fixed	19 1/4	17 1/4	24 1/2	R600a	1/8	1.74	200 lbs.
Freezer	4.2	Manual	1 Solid LH	0	2 Fixed	19	17 1/4	24 1/2		1/8	1.5	

Note: Interior dimensions are estimates and subject to change without notice.

Front View

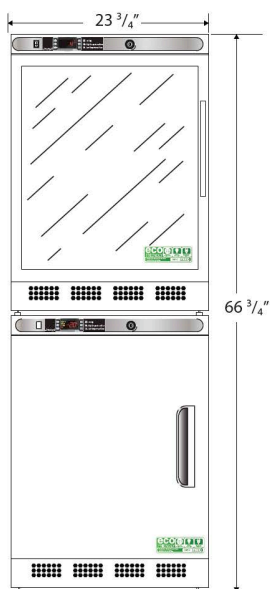

Side View

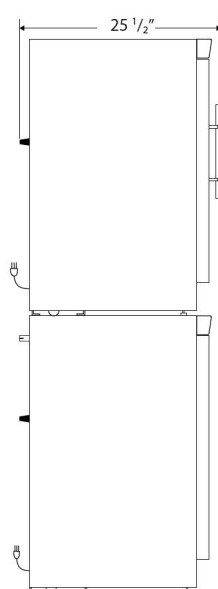

Top View

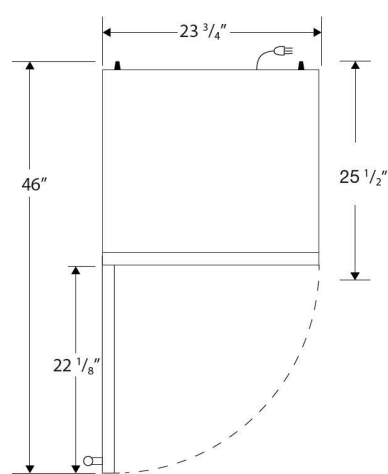

Compartment	Cu. Ft	Defrost	Door	Int Door	Shelves	Interior Dim.			Refrigerant	H.P.	Amps	Weight
						W"	D"	H"				
Refrigerator	4.6	Cycle	1 Glass LH	0	2 Adj./1 Fixed	23 3/4	25 1/2	66 3/4	R600a	1/8	1.74	200 lbs.
Freezer	4.2	Manual	1 Solid LH	0	2 Fixed					1/8	1.5	